

### Technical data

#### In general

Weight: approx. 1.2 kg  
 Rated insulation voltage according to EN60947-1: 125V for PD3 (pollution degree)  
 Ambient temperature range: -40°C up to +60°C  
 Protection: IP10 (contacts IP00)  
 Mechanical life: >10,000 operations  
 Auxiliary contacts: 1 pc. S870 NO + NC contact  
 Coil suppression: Varistor  
 Mounting position: Any, except main contacts upside down  
 Fixing: With screws M5 (max torque 2Nm)

#### Electrical data

Coil voltage  $U_{\text{nom}} = 48\text{VDC}$   
 Coil voltage range: 42V - 60V  
 Switch-on time: 100%  
 Pull-in voltage (mounting position vertical at 20°C):  $\leq 35\text{V}$   
 Coil resistance: approx. 220 Ohm at 20°C (approx. 168 Ohm at -40°C)  
 Continuous thermal current  $I_{\text{th}}$ : 400A. (Please note: Contactor and power supply result in a thermal system. Cross sections are decisive)  
 Max. inrush current: 400A/96VDC/resistive load  
 Max. breaking current: >650A/96V/resistive load  
 Electrical life for battery contactor: >150 operations at 400A/60V/resistive load  
 Electrical life for load contactor: >500 operations at 250A/60V/resistive load

Main contacts M10 (max. torque 10Nm)

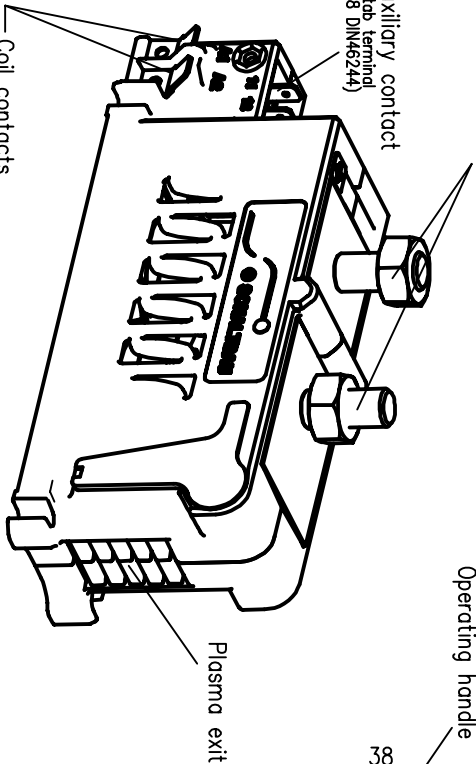

Contactor part no.: 1-1697-100212

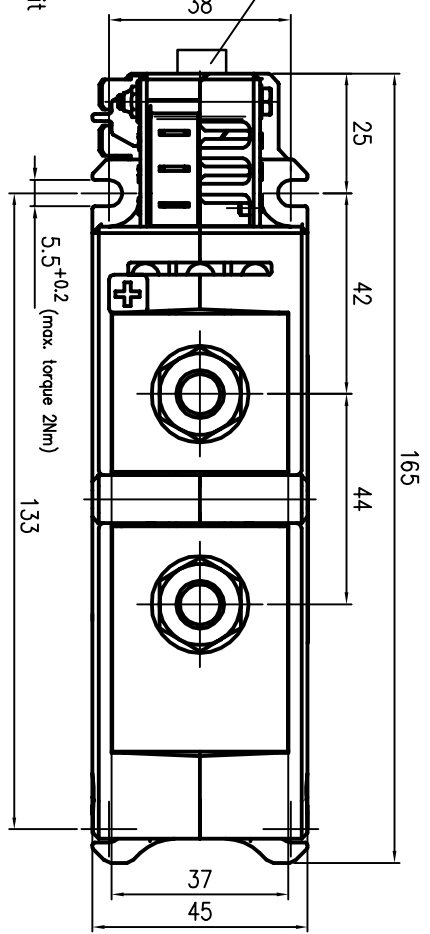
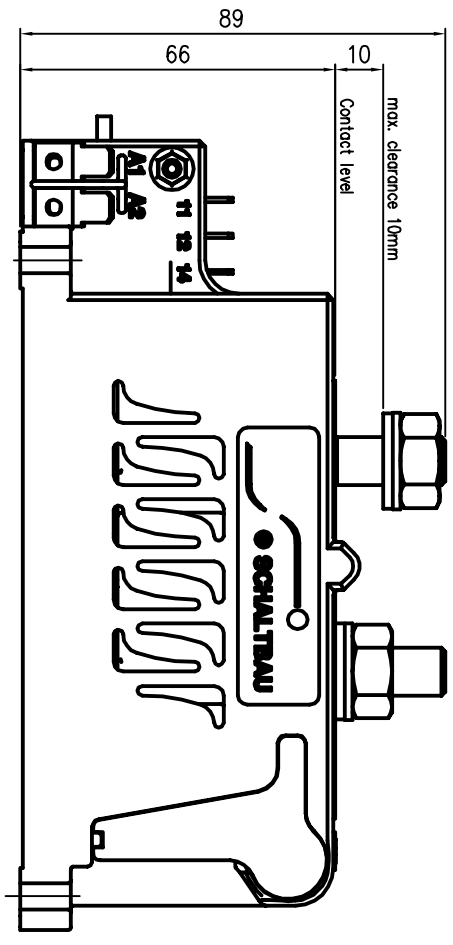
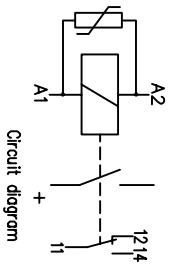

Modifications reserved!

© Schaltbau GmbH 2002

Verwendbar für:

Menge ohne Toleranzangabe ISO 2768 m	Oberfläche siehe Stückliste	Ausg. Datum	Masstab	Gewicht
Datum	Name	Werkstoff, Halbzeug, Modell-Nr.		
Bezfr. 10.09.02	WICHTLER	C400 L0/P1- 48FV-E1		
Gepfr. 10.09.02	Gishouser	Contactor Drawing		
Norm.				



1-1697-100212

Blatt 01 BR

Weitergabe sowie Vervielfältigung dieses Dokuments, Verwertung und Mitteilung seines Inhalts sind verboten, soweit nicht ausdrücklich gestattet. Zuwiderhandlungen verpflichten zu Schadenersatz. Alle Rechte für den Fall der Patent-, Gebrauchsmuster- oder Geschmuckenscheinverletzung vorbehalten. (Schutzvermerk DIN ISO 16016 beachten)