

DT 2

Photoelectric proximity switch with analogue output



Measurement range
 50 ... 300 mm
 Photoelectric proximity switch

- Analogue output
- 90° rotatable M 12 plug
- Infrared light
- 1 mm resolution

Dimensional drawing

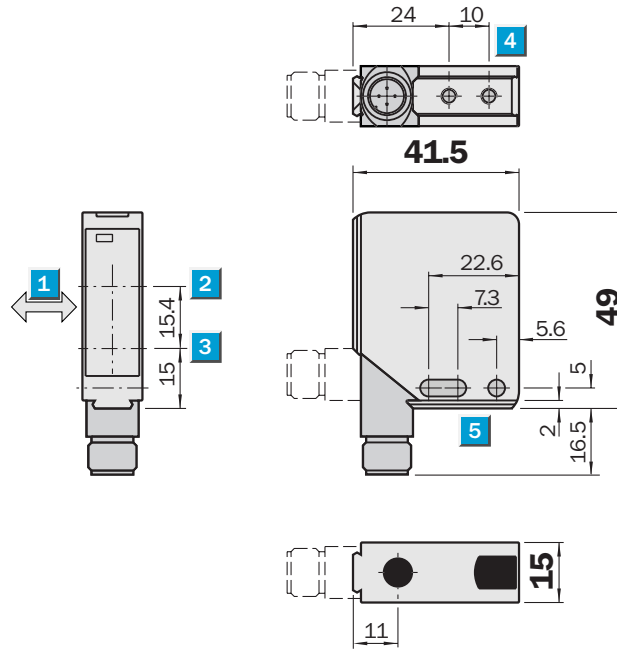

- 1 Standard direction of the material being scanned
- 2 Optical axis, receiver
- 3 Optical axis, sender
- 4 M 4 threaded mounting hole – 4 mm deep
- 5 Through borehole Ø 4.2 mm

Connection type

DT 2-410

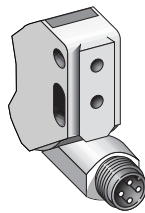

4-pin, M 12

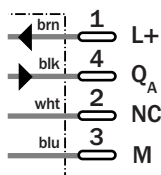

DT 2 Photoelectric proximity switch with analogue output

Technical data		DT 2-	410								
Measurement range ¹⁾	90 % remission: 50 ... 300 mm										
	6 % remission: 50 ... 250 mm										
Accuracy											
Object with 90 % remission	±8 % to current value										
Reproducibility											
Object with 90 % remission	3 % to 200 mm										
	5 % to 300 mm to current value										
Light source ²⁾ , light type											
	Infrared, 880 nm										
Light spot diameter	80 mm at 300 mm										
Supply voltage V_s											
	18 ... 30 V DC ³⁾										
Ripple ⁴⁾	< 5 V_{PP}										
Current consumption ⁵⁾	< 100 mA										
Analogue output											
	4–20 mA										
Response time	200 ms										
Resolution	1 mm										
Connection type											
	Plug, M 12, 4-pin										
VDE protection class ⁶⁾											
	ⓘ										
Enclosure rating											
	IP 67										
Ambient temperature T_A											
	Operation –10 °C ... +45 °C										
	Storage –25 °C ... +75 °C										

¹⁾ Falling below of the measurement range results in ambiguous values
Exceeding the measurement range results in values = 20.3 mA

²⁾ Average service life 100,000 h
at $T_A = +25\text{ °C}$

³⁾ Limit values, reverse-polarity protected

⁴⁾ May not exceed or fall short of V_s tolerances

⁵⁾ Without load

⁶⁾ Reference voltage DC 30 V

Order Information	
Type	Part no.
DT 2-410	1 024 093

Great Britain

Erwin Sick Ltd.
Waldkirch House
39 Hedley Road, St. Albans
Hertfordshire AL 1 5BN
☎ +44 17 27-83 11 21
Fax +44 17 27-85 67 67
info@sick.co.uk

USA

SICK, Inc.
6900 West 110th Street
Bloomington, MN 55438
☎ +1 (952) 9 41-67 80
Fax +1 (952) 9 41-92 87
WATS: 1-800-325-7425
info@sickusa.com

Australia

Sick Pty. Ltd. Head Office
P.O. Box 214
899 Heidelberg Road
Ivanhoe, Vic. 3079, Australia
☎ +61 39 49 74 10 0
(0 08) 33 48 02 - toll free
Fax +61 39 49 71 18 7
sales@sick.com.au

SICK